

S P E C I F I C A T I O N S

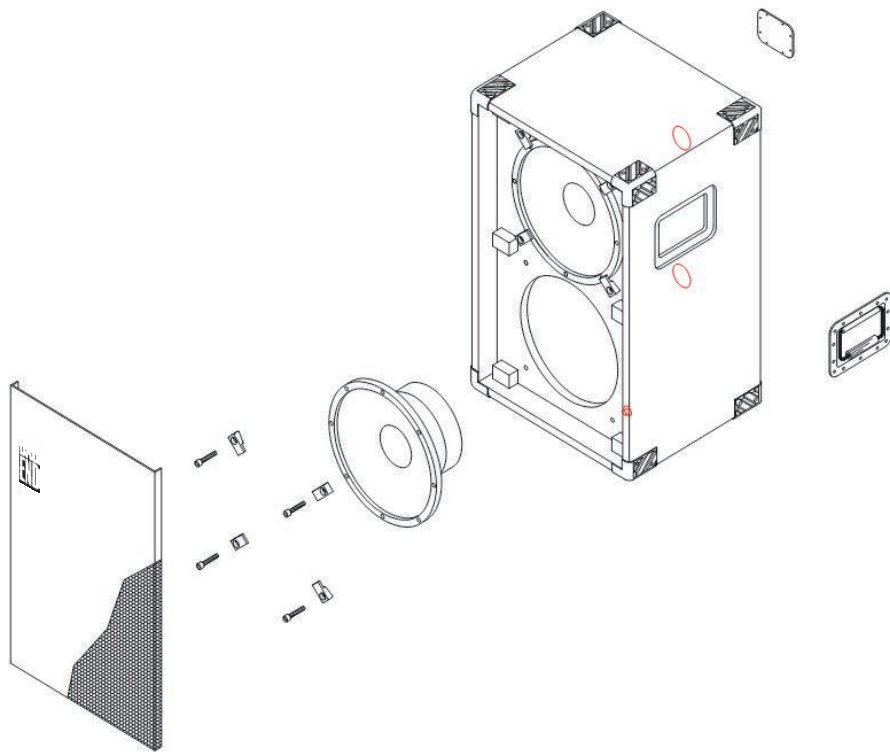

SYSTEM COMPONENTS

Enclosure:
3/4" 7-ply poplar plywood

Transducers:
Two 12" Redrock cone
?2.5" Voice coil
?60 oz. Magnet

Input Connectors:
One Dual Banana
Two 1/4" Phone

Standard Hardware:
Two Handles
Eight Extruded aluminum
clamps
Eight Protective corners

ACOUSTIC AND ELECTRICAL

System Type:
Rear vented 3 ft³

Impedance:
4 Ω

Driver DCR:
6.6 Ω

Frequency Response:
?? \pm 3dB 50 Hz to 6 kHz
(4 π Steradians)

Sensitivity:
?100dB SPL/1 Watt/1 Meter

Power Handling Capacity:
?75 Watts continuous sine
wave
?150 Watts instantaneous
peak

PHYSICAL

Finish:
Deep Red carpet

Grille:
16 gauge black vinyl coated
perforated steel

Dimensions:
?28"h x 23"w x 12.5"d
71cm x 58cm x 32cm

Weight:
?94 lbs.
43kg

Shipping Dimensions:
?21" x 25" x 15"
53cm x 64cm x 38cm

Shipping Weight:
?66 lbs.
30kg



BAG END Loudspeakers
1201 Armstrong St.
Algonquin, IL 60102
USA

Voice 847 658 8888
Fax 847 658 5008
www.bagend.com



D12R-D

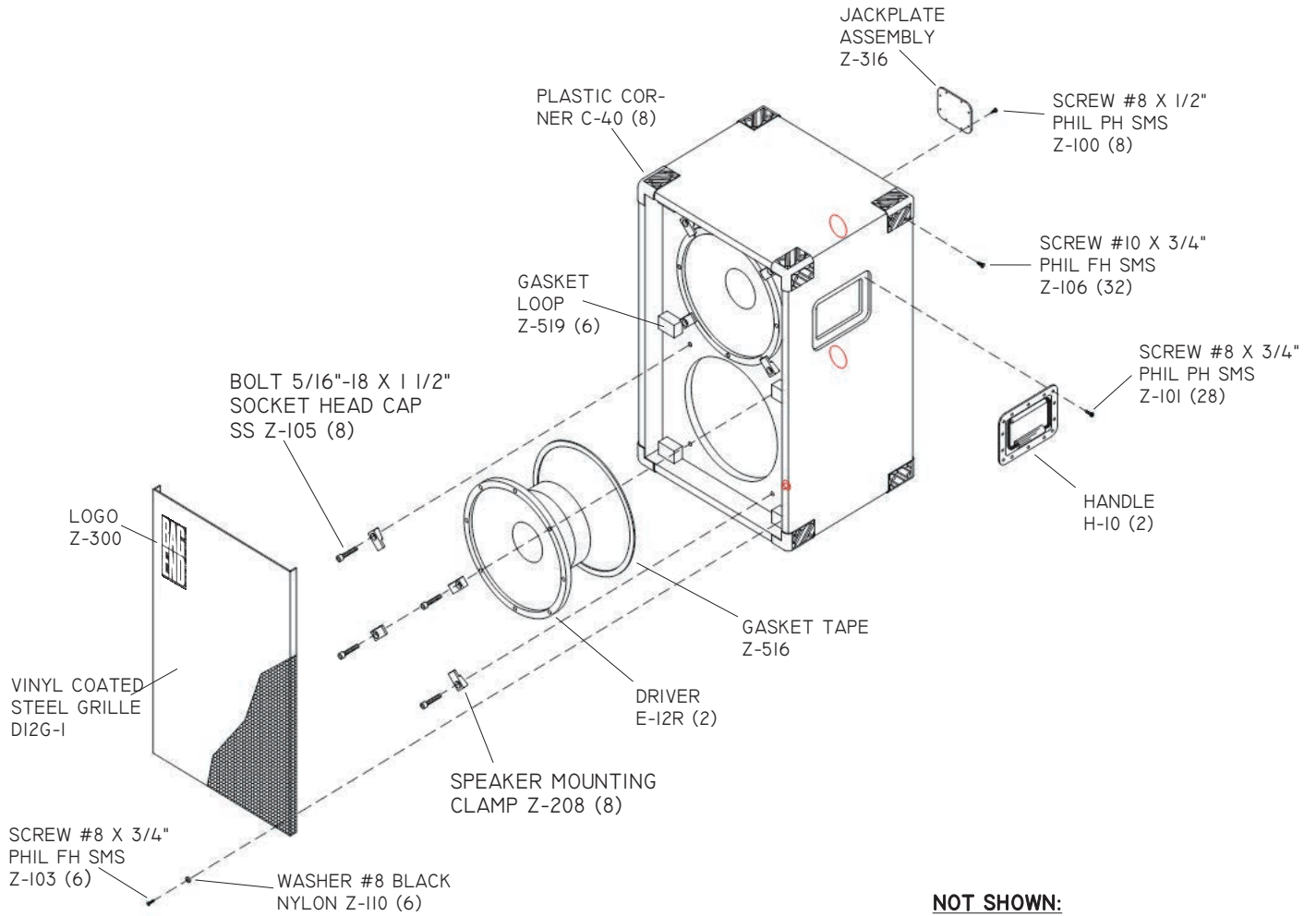

NOT SHOWN:

- ACOUSTIC DAMPENER Z-500 (10)
- SHIPPING CARTON Z-605 (1)
- PLASTIC BAG Z-627 (1)
- EDGE GUARD Z-630 (24)

SYSTEM SCHEMATIC

